



Ceramic Screw Hexagon Socket head [Metric]

KDA Standard Ceramic Screws

Manufactured by KDA's "3D Slip Cast®" method.

We accept your order more than 10 pcs per a model ID.

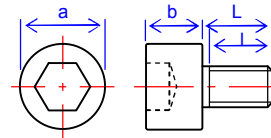

Hexagon Socket head [Metric]				Alumina Al2O3 [JPY]		Zirconia ZrO2 [JPY]			
Size	Pitch	a	b	L	l	Model ID	Unit Price	Model ID	Unit Price
M2	0.4	3.8	1.9	3	2	ARAM02-03	960	ZRAM02-03	1,490
				5	4	ARAM02-05	1,020	ZRAM02-05	1,580
				8	6.5	ARAM02-08	1,090	ZRAM02-08	1,680
				10	8.5	ARAM02-10	1,170	ZRAM02-10	1,780
M3	0.5	5.5	3	5	4	ARAM03-05	1,010	ZRAM03-05	1,590
				8	6.5	ARAM03-08	1,040	ZRAM03-08	1,640
				10	8.5	ARAM03-10	1,070	ZRAM03-10	1,680
				12	10.5	ARAM03-12	1,120	ZRAM03-12	1,770
				16	14.5	ARAM03-16	1,180	ZRAM03-16	1,830
M4	0.7	7	4	20	15	ARAM03-20	1,260	ZRAM03-20	1,910
				8	6.5	ARAM04-08	1,070	ZRAM04-08	1,680
				10	8.5	ARAM04-10	1,120	ZRAM04-10	1,770
				12	10.5	ARAM04-12	1,180	ZRAM04-12	1,860
				16	14.5	ARAM04-16	1,240	ZRAM04-16	1,980
M5	0.8	8.5	5	20	15	ARAM04-20	1,410	ZRAM04-20	2,240
				25	15	ARAM04-25	1,510	ZRAM04-25	2,340
				8	6.5	ARAM05-08	1,120	ZRAM05-08	1,770
				10	8.5	ARAM05-10	1,180	ZRAM05-10	1,860
				12	10.5	ARAM05-12	1,240	ZRAM05-12	1,960
				16	14.5	ARAM05-16	1,300	ZRAM05-16	2,050
M6	1	10	5.8	20	15	ARAM05-20	1,480	ZRAM05-20	2,340
				25	15	ARAM05-25	1,600	ZRAM05-25	2,510
				30	15	ARAM05-30	1,700	ZRAM05-30	2,610
				8	6.5	ARAM06-08	1,240	ZRAM06-08	1,960
				10	8.5	ARAM06-10	1,300	ZRAM06-10	2,050
				12	10.5	ARAM06-12	1,360	ZRAM06-12	2,150
				16	14.5	ARAM06-16	1,480	ZRAM06-16	2,340
				20	15	ARAM06-20	1,600	ZRAM06-20	2,510
M8	1.25	13	7.8	25	15	ARAM06-25	1,650	ZRAM06-25	2,600
				30	15	ARAM06-30	1,720	ZRAM06-30	2,700
				35	15	ARAM06-35	1,800	ZRAM06-35	2,800
				40	15	ARAM06-40	1,880	ZRAM06-40	2,900
				10	8.5	ARAM08-10	1,360	—	—
				12	10.5	ARAM08-12	1,480	—	—
				16	14.5	ARAM08-16	1,540	—	—
				20	15	ARAM08-20	1,650	—	—
M10	1.5	16	9.8	25	15	ARAM08-25	1,720	—	—
				30	15	ARAM08-30	1,770	—	—
				35	15	ARAM08-35	1,830	—	—
				40	15	ARAM08-40	1,900	—	—
				45	15	ARAM08-45	1,980	—	—
				10	8.5	ARAM10-10	1,480	—	—
				12	10.5	ARAM10-12	1,540	—	—
				16	14.5	ARAM10-16	1,600	—	—
20	15	ARAM10-20	1,720	—	—				
25	15	ARAM10-25	1,770	—	—				
30	15	ARAM10-30	1,830	—	—				
35	15	ARAM10-35	1,910	—	—				
40	15	ARAM10-40	2,000	—	—				
45	15	ARAM10-45	2,090	—	—				

KDA Ceramic Screws are suitable for RoHS.
There is a possibility to change this price chart above without notice.